



For the patient

Sample collection guidelines: First voided urine (FVU)

Guidelines for the patient

Procedure for **women**:

- Wash hands.
- Spread the labia.
- Collect the first 10ml of urine in the container. Do not touch the inside.
- Empty the bladder further into the toilet.
- Wash hands.

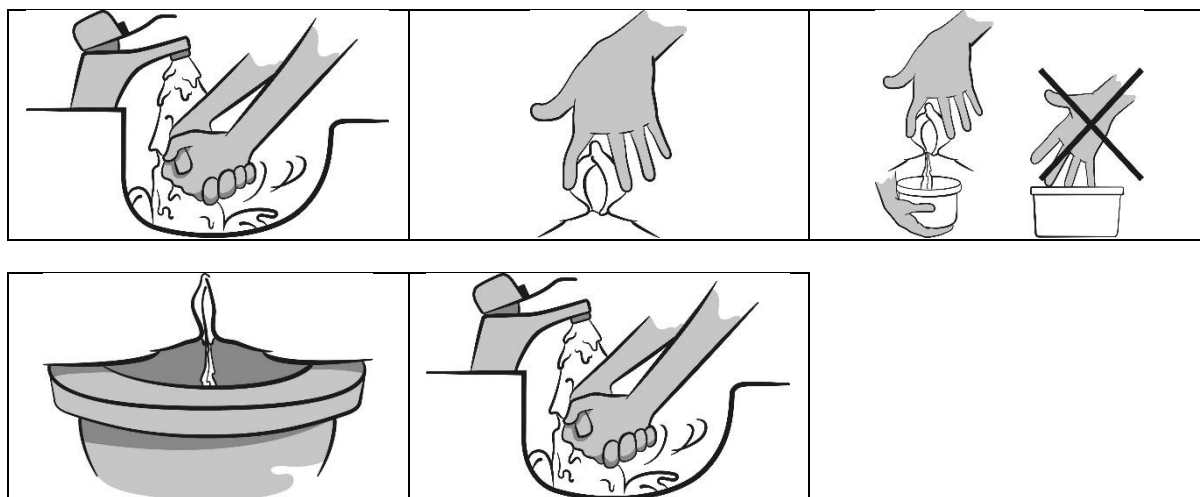

Procedure for **men**:

- Wash hands.
- Bring the foreskin backwards.
- Collect the first 10ml of urine in the container. Do not touch the inside.
- Empty the bladder further into the toilet.
- Wash hands.

